



# Tangential-flow hollow cone nozzles

## Series 373 „Ramp Bottom“ /309



**Fine, uniform hollow cone spray, also at low pressures.**

Applications:

cooling and cleaning of gas, water re-cooling, dust control, chemical process engineering.



Sectional view of a series 373 „Ramp Bottom“ nozzle

„Ramp Bottom“ design offering a longer service life, due to the patented „sloping“ bottom of mixing chamber.

**Dimensions**

BSPP	L [mm]	D [mm]	H [mm]	E [mm]	Hex	Weight bronze [g]
1	67	45	52	6,3	41	300
1 1/4	77	51	65	7,9	48	600
1 1/2	97	65	81	7,9	58	950

Series 373 „Ramp Bottom“

**Less expensive plastic version, with low requirements on temperature and scuff resistance.**

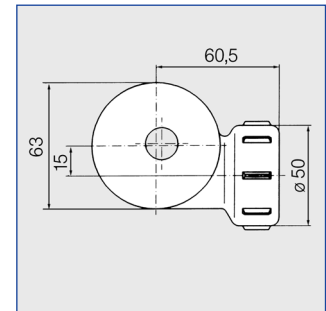
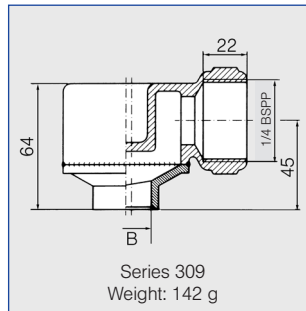

★ Spray angle	Ordering no.						B ∅ [mm]	V̇ [l/min]						Spray diameter D at p = 2 bar	
	Type	Mat. no.		Code		p [bar]									
		32 Bronze	17 1.4571/316 SS	1 BSPP	1 1/4 BSPP	1 1/2 BSPP		0,3	0,5	1,0	2,0			5,0	10,0
<b>70°</b>	<b>373. 115</b>	○	○	<b>AN</b>	-	-	11,40	24,40	31,50	44,5	63,00	99,60	141,00	650	1300
<b>80°</b>	<b>373. 175</b>	○	○	<b>AN</b>	-	-	12,90	31,00	40,00	56,60	80,00	126,00	179,00	800	1550
	<b>373. 235</b>	○	○	-	<b>AQ</b>	-	16,20	45,70	59,00	83,40	118,00	187,00	264,00	700	1350
	<b>373. 285</b>	○	○	-	<b>AQ</b>	-	20,50	62,00	80,00	113,00	160,00	253,00	358,00	800	1550
	<b>373. 325</b>	○	○	-	-	<b>AS</b>	22,20	77,50	100,00	141,00	200,00	316,00	447,00	800	1550
	<b>373. 365</b>	○	○	-	-	<b>AS</b>	23,60	67,90	114,00	161,00	227,00	359,00	508,00	700	1400

**Plastic version:**

<b>90°</b>	<b>309. 236. 5E</b>	<b>(Material PVDF)</b>	20,00	45,70	59,00	83,40	118,00	187,00	264,00	850	1500
	<b>309. 286. 5E</b>	<b>(Material PVDF)</b>	24,00	62,00	80,00	113,00	160,00	253,00	358,00	750	1400

B = bore diameter

**Example**    Type + Material no. + Code = Ordering no  
for ordering: 373. 115 + 32                    + AN = 373. 115. 32. AN

Conversion formula for the above series:  $\dot{V}_2 = \dot{V}_1 \cdot \sqrt{\frac{p_2}{p_1}}$

