

Tangential-flow hollow cone nozzles

Brass versions

Series 302/308



Uniform hollow cone spray. Non-clogging nozzle, with- out swirl insert.

Applications:

Humidification of air in air washers, dust control, spraying onto filters, foam control, cooling.

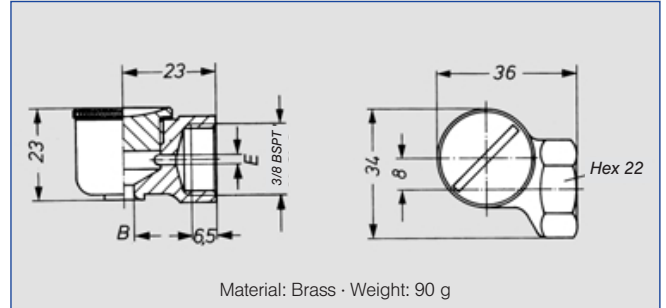

Spray angle	Ordering no.		B Ø [mm]	E Ø [mm]	\dot{V} [l/min]							Spray diameter D at p = 2 bar	
	Type	Mat. no.			p [bar]							 H = 250 mm H = 500 mm	
60°	302. 364	○	1,50	1,50	0,31	0,45	0,63	0,77	1,00	1,18	1,41	200	350
	302. 464	○	2,00	2,00	0,70	0,99	1,40	1,71	2,21	2,62	3,13	200	350
80°	302. 545	○	2,90	2,90	1,12	1,58	2,24	2,74	3,54	4,19	5,01	410	730
90°	302. 606	○	4,60	4,00	1,57	2,23	3,15	3,86	4,98	5,89	7,04	480	900
130°	302. 368	○	3,00	1,00	0,31	0,45	0,63	0,77	1,00	1,18	1,41	1400	1700
	302. 468	○	5,00	1,70	0,70	0,99	1,40	1,71	2,21	2,62	3,13	1400	1700
	302. 548	○	5,00	2,50	1,12	1,58	2,24	2,74	3,54	4,19	5,01	1400	1800
	302. 608	○	5,00	3,50	1,57	2,23	3,15	3,86	4,98	5,89	7,04	1400	1800
	302. 668	○	7,50	3,60	2,25	3,18	4,50	5,51	7,12	8,42	10,06	1500	2000
	302. 748	○	7,50	4,80	3,55	5,02	7,10	8,70	11,23	13,28	15,88	1500	2000

B = bore diameter · E = narrowest free cross section

Flow rate adjustable. Decrease in flow rate causes narrower spray angle.

Applications:

Dust control, foam control.

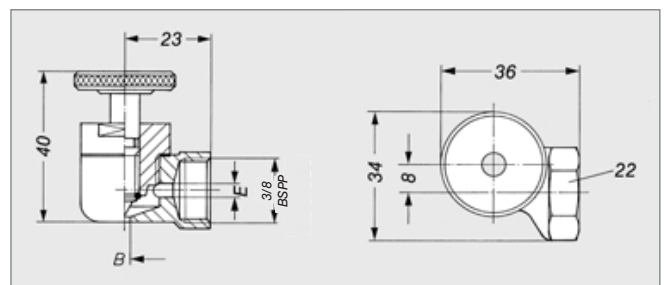

Strahlwinkel	Bestell-Nr.		B Ø [mm]	E Ø [mm]	\dot{V}_{max} [l/min]						Spray diameter D at p = 2 bar	
	Type	Mat.- Nr.			p [bar]						 H = 250 mm H = 500 mm	
90°	308. 466	○	2,0	2,0	0,54	0,70	1,00	1,40	2,21	3,13	400	880
	308. 606	○	4,0	4,0	1,22	1,58	2,23	3,15	4,98	7,04	450	950

B = bore diameter · E = narrowest free cross section

Example	Type	+	Material no.	=	Ordering no.
for ordering	308. 466	+	30	=	308. 466. 30

